

REV.	DESCRIPTION	ECN	DATE	BY
A	NEW DRAWING	7205	9/30/2009	EFR

ITEM NO.	SRK117/QTY.	PART NUMBER	OLD PART NUMBER	DESCRIPTION
1	1	CHART	CHART	TIE ROD END
2	1	143699-0113	19497	COTTER PIN - TIE ROD ASSY

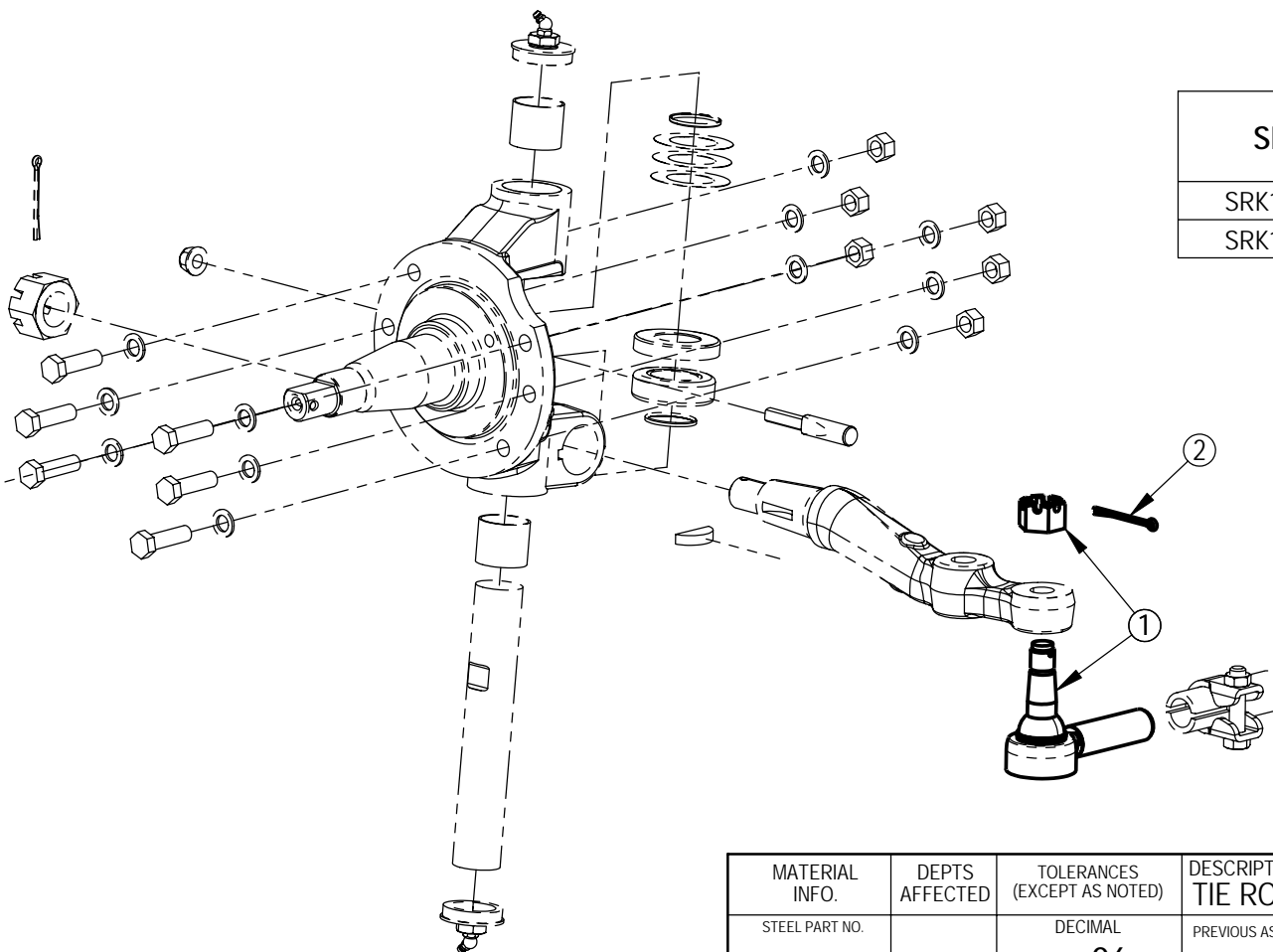

SRK	ITEM #1 PART NO.	ITEM #1 OLD PART NO.
SRK117-10	143640-0034	19108-020-10
SRK117-20	143640-0035	19108-020-20

SPECIAL CHARACTERISTICS SYMBOL LEGEND	
(X.XX)	W/C CRITICAL DIM
** X.XX	DESIGNATES A ± .125 TOL.
* X.XX	DESIGNATES A KEY CUSTOMER CHARACTERISTIC
KEY CUSTOMER CHARACTERISTICS SYMBOLS	
KCC	NAVISTAR/INTERNATIONAL
K	FREIGHTLINER
M	MACK TRUCKS
C	PACCAR

NOTE: PARENTHESIS ( ) DENOTES REFERENCE DIMENSION

MATERIAL INFO.	DEPTS AFFECTED	TOLERANCES (EXCEPT AS NOTED)	DESCRIPTION: TIE ROD END REPAIR KIT SL0851 (WESTPORT)		
STEEL PART NO.	-	DECIMAL ± .06	PREVIOUS ASSY:	-	
MATERIAL:	-	FRACTIONAL ± 1/16	SUSPENSION MODEL:	SCALE:	SL08XX 1:6
WEIGHT:	-	ANGULAR ± 1.0°	DATE:	DRAWN BY:	09/30/09 EFR
			SIZE:	DRAWING NO:	
			A	SRK117	

