

LEVEL	REVISION DESCRIPTION	ECN	DATE	BY
A	NEW DRAWING	2108	4/12/99	GWF
B	SWAPPED PORTS 2 & 4	2177	8/22/99	CBG
C	ADDED CHART & DETAIL 2	2257	5/10/00	JFF
D	SWITCH PORTS ON LOADLIFT BAG ON DETAIL 2	2285	6/15/00	JFF
E	WAVE WORKS TO INCLUDE WASHDOWN	-	2/5/01	CBG
F	ADDED ACK-106-02	2924	8/05/03	JFF
G	ITEM #7 WAS 17312	3044	11/10/03	JFF
H	UPDATED ITEM #1	3058	11/05/04	JFF
I	CLARIFIED PORT NUMBERING	3192	4/27/04	JFF

ITEM	PART NO.	QTY.	DESCRIPTION
1	CHART	1	LIFT AXLE CONTROL MODULE
2	10100	1	BRAKE PROTECTION VALVE
3	10099	2	QUICK RELEASE VALVE
4	17347	1	RELAY SWITCH
5	CHART	1	WEATHER BOX

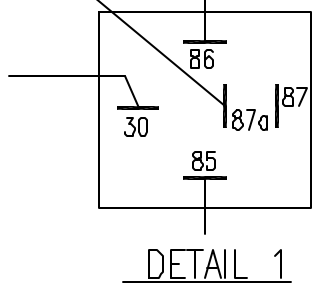
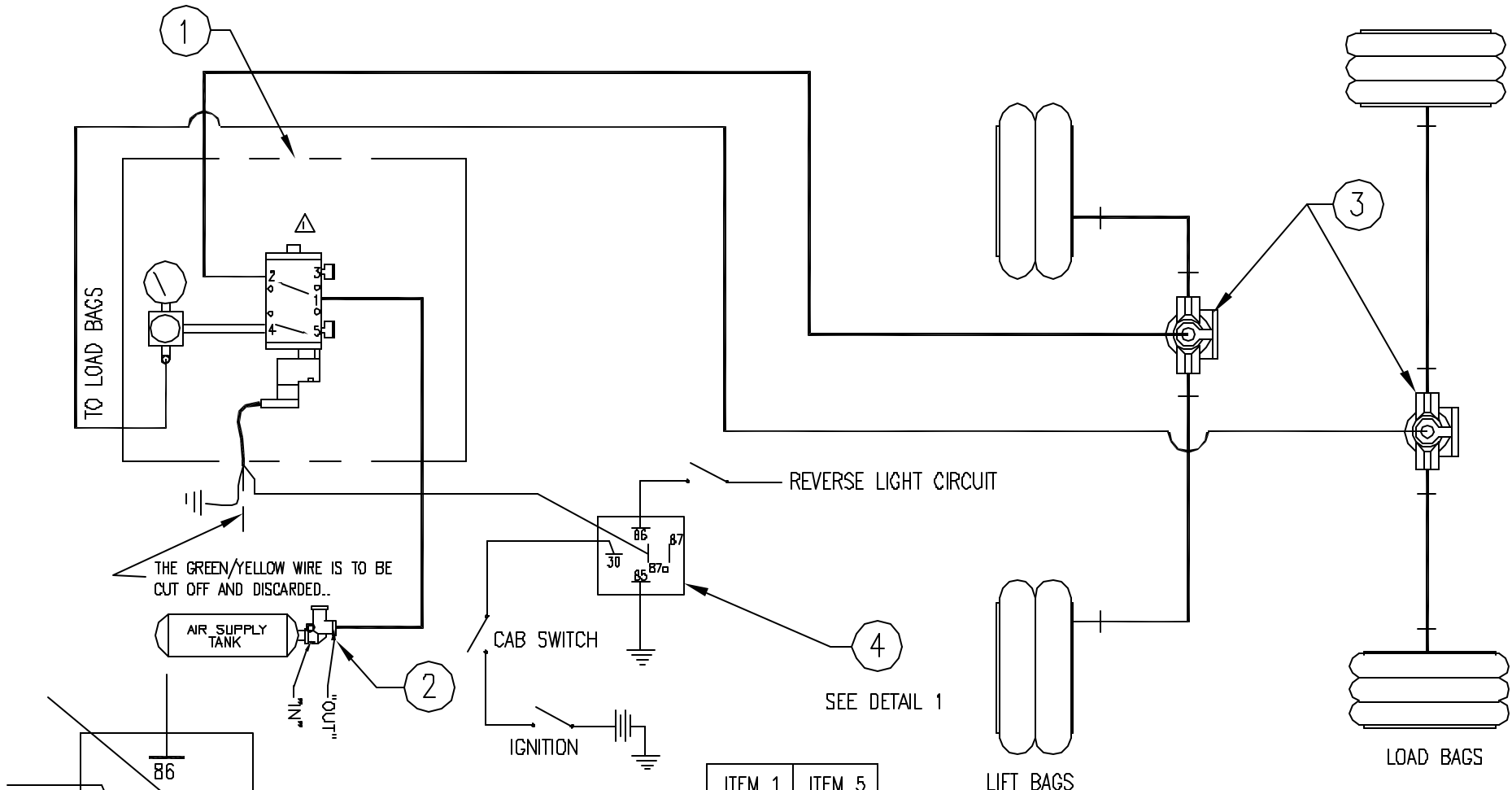

		ITEM 1	ITEM 5
OBSOLETE	ACK106	17954 NORGREN	
OBSOLETE	ACK106-01	17386 MAC	
	ACK106-02	990251	N/A
	ACK106-01WB	990251	17532

DEPARTMENTS AFFECTED	TOLERANCES (EXCEPT AS NOTED)	WATSON & CHALIN MFG., INC.				
20	DECIMAL ± .06	DESCRIPTION ELECTRIC CONTROL USING MANIFOLD VALVE				
-	FRACTIONAL ± 1/16	SUSPENSION MODEL	SCALE	PREVIOUS ASSEMBLY		
-	ANGULAR ± 1°	-	NTS	-		
		DATE	CHKD BY	DRAWN BY	SIZE	DRAWING NO.
		4/12/99	-	GWE	A	ACK-106