

REV.	DESCRIPTION	ECN	DATE	BY
A	NEW DRAWING	C-4261	10/23/2006	TEG
B	CHNGD QTY OF ITEM #1 FROM 4 TO 8; CHNGD QTY OF #2 FROM 8 TO 16; RMVD #4(PART NO. 17057); #5 WAS 19040-075F	C-4930	10/11/2007	HDH
C	ADDED BUSHING GREASE DETAIL TO DRAWING	C-5340	04/17/2008	DRB
D	ADDED TORQUE SPECS TO DRAWING	C-5340	05/12/2008	DRB
E	ADDED ISO DETAIL; UPDATED CHARTS	C-5561	06/24/2008	TLK



SERVICE REPAIR KIT SRK1190-1			SL1190 BUSHING REPAIR KIT	
ITEM	PART NO.	QTY	DESCRIPTION	
1	10033	8	CAPSCREW .75 X 5.00 UNF GR8	
2	10043	16	WASHER FLAT .75 HARDENED	
3	12927-03	8	WASHER FLAT .78X3.25X.25	
4	-	-	-	
5	10028	8	NUT LOCK .75 UNF GR8	
6	19204	16	BUSHING POLY FLANGE SL1190	
7	91031	8	BUSHING SLEEVE SL1190	

**Torque Requirement Procedures**

All fasteners should be re-torqued according to the following schedule.

- after 5 days
- after 30 days
- after 60 days
- every 6 months thereafter

**Capscrew/Bolt (Grade 8 UNF) TORQUE Requirements**

Capscrew/Bolt Size	3/8"	1/2"	5/8"	3/4"	3/4" (Stabilizer Shock Stud)	7/8"	1"	1 1/8"
Torque minimum ft./lbs.	25	50	150	300	200	500	700	900
Torque maximum ft./lbs.	35	75	200	350	250	550	800	1000

**NOTE**

Torque Values do not apply to air springs or lower grade fasteners.

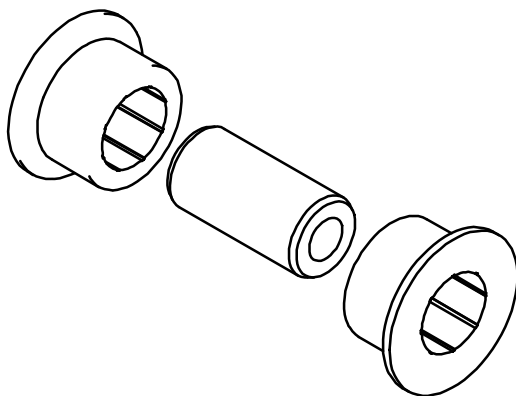

COAT BOTH INNER AND OUTER DIAMETER OF POLY BUSHING SURFACES WITH LUBRICANT-CURRENT SPEC. CHEVRON ULTI-PLEX EP-NLGI2

MATERIAL INFO:	DEPTS AFFECTED	TOLERANCES (EXCEPT AS NOTED)	DESCRIPTION: SRK KIT SL1190 BUSHING	
STEEL PART NO.	-	DECIMAL ± .03	PREVIOUS ASSY:	-
MATERIAL:	-	FRACTIONAL ± 1/32	SUSPENSION MODEL:	SCALE: 1:1
WEIGHT:	-	ANGULAR ± 0.5°	DATE: 10/23/06	DRAWN BY: TEG
			SIZE: A	DRAWING NO: SRK1190-1

